

# MINI PONY PROFILE 20°/38° DMX

LED THEATRE

TRADITIONAL THEATRE

STAGE

DIMMER

CONSOLE



Sagomatore maneggevole dalle dimensioni compatte, con sorgente a LED da 50 W, controllato da segnale DMX (DALI a richiesta), regolazione manuale dello zoom e del focus, completo di telaio porta gelatina. Segnali di controllo DMX512, WIRELESS DMX(OPTIONAL), DALI (POTIONAL). Funzioni stand-alone con controllo locale dell'intensità. Frequenza PWM regolabile da 300Hz a 4Khz. Risoluzioni del dimmer a 8 bit, conversione software 8-11 bit, 16 bit. Presa USB per aggiornamento software.

Handy profile with small dimensions, with 50W LED source, 20°/38° optics, dmx dimming control, stand alone functions, manual regulation of zoom and focus, complete with color frame. Control signals: DMX512, DALI (OPTIONAL), WIRELESS DMX (optional). Stand-alone functions with local control of intensity. PWM can be set via display from 300Hz to 4Khz in not even steps. Resolution 8/ 8-11Bit conversion /16 Bit. USB port for software update.

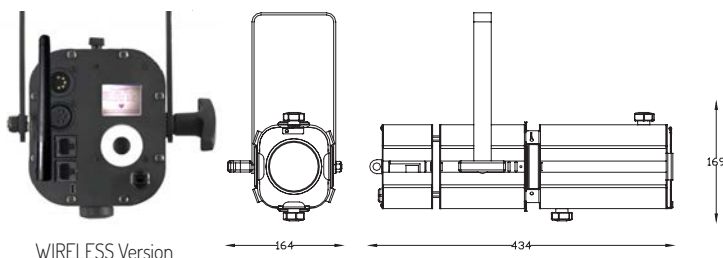

## DATI TECNICI - TECHNICAL DATA



100/240V AC



50 W



COB  
BRIDGELUX

CRI

90



EXTRUDED ALUMINIUM  
+ STEEL SHEETS



2,8 Kg

IP

20



EPOXIDIC POWDER

## VARIANTI - OPTIONS

Cod.	Temperatura Colore Color Temperature	WIRELESS	Dimensioni porta accessori Accessori frame dimensions	Dimensione gobo Gobos dimension	Ottica Optics	€
9812006605	3000K		98x114mm	M	20° - 38°	
9812007190	3000K	✓	98x114mm	M	20° - 38°	
9812046505	5600K		98x114mm	M	20° - 38°	
9812007193	5600K	✓	98x114mm	M	20° - 38°	

## ACCESSORI - ACCESSORIES

Cod. 0400010005 COLOR FRAME	Cod. 1500004500 IRIS DIAPHRAGM
Cod. 0801000005 GOBO HOLDER SIZE - M	Cod. 9184000000 SINGLE TRUSSCLAMP
Cod. 1300004505 HOOK CLAMP	Cod. 1400500000 Ø3MM STEEL SAFETY BOND

## DATI FOTOMETRICI - PHOTOMETRIC DATA

### FASCIO LARGO

in focus beam - fascio a fuoco

Dist. m	2	3	4	5	6	7	8	9
Lux	4388	1950	1097	702	488	358	274	217
Diam. m	1,3	2,0	2,7	3,3	4,0	4,7	5,3	6,0

### FASCIO STRETTO

in focus beam - fascio a fuoco

Dist. m	2	3	4	5	6	7	8	9
Lux	7313	3250	1828	1170	813	597	457	361
Diam. m	0,6	0,9	1,2	1,6	1,9	2,2	2,5	2,8